

STAINLESS GROUND SHAFTS

DIAMETER	MATERIAL
3/8"	303 STAINLESS STEEL

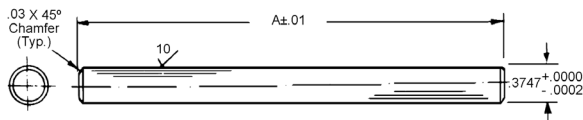
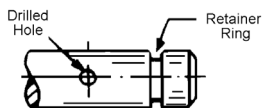

TYPICAL MODIFICATIONS

- Precision ground finish
- Straight within .0004 in./in.
- Send sketch for quotation on modifications

Available on request:

- Retainer ring grooves
- Special shaft lengths
- Journals
- Drilled holes
- Milled flats

STOCK NO.	A
S6-18	1.875
S6-20	2.000
S6-21	2.125
S6-22	2.250
S6-23	2.375
S6-25	2.500
S6-26	2.625
S6-27	2.750
S6-28	2.875
S6-30	3.000
S6-31	3.125
S6-32	3.250
S6-33	3.375
S6-35	3.500
S6-36	3.625
S6-37	3.750
S6-38	3.875
S6-40	4.000
S6-41	4.125
S6-42	4.250

STOCK NO.	A
S6-43	4.375
S6-45	4.500
S6-46	4.625
S6-47	4.750
S6-48	4.875
S6-50	5.000
S6-52	5.250
S6-55	5.500
S6-57	5.750
S6-60	6.000
S6-62	6.250
S6-65	6.500
S6-67	6.750
S6-70	7.000
S6-72	7.250
S6-75	7.500
S6-77	7.750
S6-80	8.000
S6-82	8.250
S6-85	8.500

STOCK NO.	A
S6-87	8.750
S6-90	9.000
S6-95	9.500
S6-100	10.000
S6-110	11.000
S6-120	12.000
S6-130	13.000
S6-140	14.000
S6-150	15.000
S6-160	16.000
S6-180	18.000
S6-200	20.000
S6-220	22.000
S6-240	24.000
S6-260	26.000
S6-280	28.000
S6-300	30.000
S6-320	32.000
S6-340	34.000
S6-360	36.000

DIAMETER	MATERIAL
1/2"	303 STAINLESS STEEL

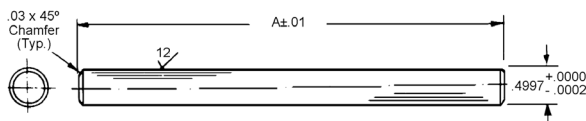

TYPICAL MODIFICATIONS

- Precision ground finish
- Straight within .0004 in./in.
- Send sketch for quotation on modifications

Available on request:

- Retainer ring grooves
- Special shaft lengths
- Journals
- Drilled holes
- Milled flats

STOCK NO.	A
S8-20	2.000
S8-21	2.125
S8-22	2.250
S8-23	2.375
S8-25	2.500
S8-26	2.625
S8-27	2.750
S8-28	2.875
S8-30	3.000
S8-31	3.125
S8-32	3.250
S8-33	3.375
S8-35	3.500
S8-36	3.625
S8-37	3.750
S8-38	3.875
S8-40	4.000
S8-41	4.125
S8-42	4.250

STOCK NO.	A
S8-43	4.375
S8-45	4.500
S8-46	4.625
S8-47	4.750
S8-48	4.875
S8-50	5.000
S8-52	5.250
S8-55	5.500
S8-57	5.750
S8-60	6.000
S8-62	6.250
S8-65	6.500
S8-67	6.750
S8-70	7.000
S8-72	7.250
S8-75	7.500
S8-77	7.750
S8-80	8.000
S8-85	8.500

STOCK NO.	A
S8-90	9.000
S8-95	9.500
S8-100	10.000
S8-110	11.000
S8-120	12.000
S8-130	13.000
S8-140	14.000
S8-150	15.000
S8-160	16.000
S8-180	18.000
S8-200	20.000
S8-220	22.000
S8-240	24.000
S8-260	26.000
S8-280	28.000
S8-300	30.000
S8-320	32.000
S8-340	34.000
S8-360	36.000